

# SNAP-ON CONTACTS



- Economical and reliable contacts are ideal for molded cases with self contained battery compartments
- Solder "ear" to facilitate soldering of wire lead
- Unique spring tension contact adjusts to variations in battery length
- Reliable spring tension contacts assure low contact resistance
- Clips easily onto .060 (1.52) to .070 (1.78) wall
- Sharp barbs securely anchor contact in place

Refer to page 34 for Battery Contact Layout & Mounting Details

## "AAA" • "AAAA" • "N" • "12V"



**CAT. NO. 204**

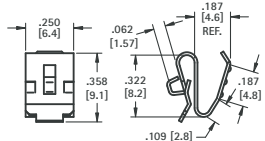

**MATERIAL:** .010 (.25) Spring Steel, Nickel Plate



**CAT. NO. 238**

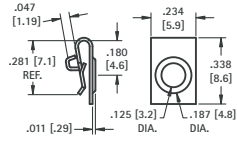

**MATERIAL:** .010 (.25) Spring Steel, Nickel Plate



**CAT. NO. 202**

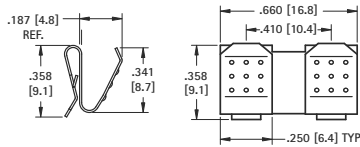

**MATERIAL:** .010 (.25) Spring Steel, Nickel Plate



**CAT. NO. 294**

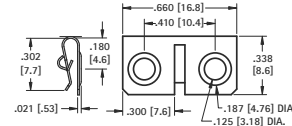

**MATERIAL:** .010 (.25) Spring Steel, Nickel Plate



**CAT. NO. 295**

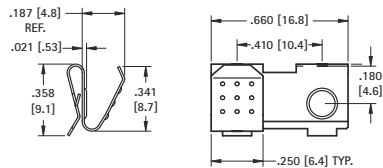

**MATERIAL:** .010 (.25) Spring Steel, Nickel Plate



**CAT. NO. 296**

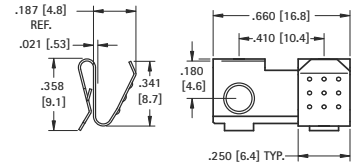

**MATERIAL:** .010 (.25) Spring Steel, Nickel Plate

## "AA" • "CR2" • "A"



**CAT. NO. 209**

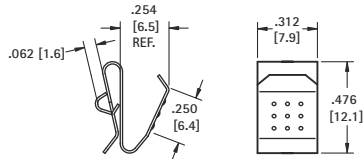

**MATERIAL:** 012 (.30) Spring Steel, Nickel Plate



**CAT. NO. 228**

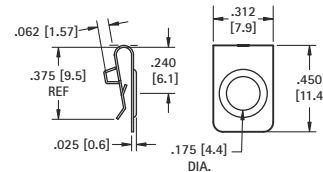

**MATERIAL:** 010 (.25) Spring Steel, Nickel Plate

## "AA"



**CAT. NO. 288**

- The (2) two leaf contacts are separate, allowing a divider between the batteries.

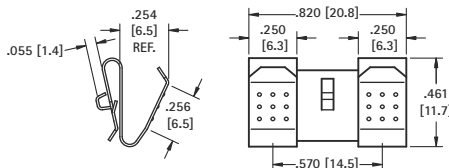

**MATERIAL:** 012 (.30) Spring Steel, Nickel Plate

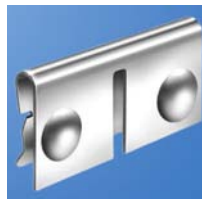

**CAT. NO. 292**

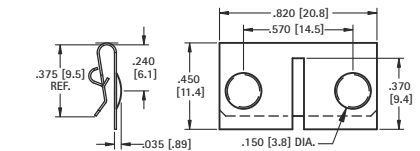

**MATERIAL:** 010 (.25) Spring Steel, Nickel Plate



**CAT. NO. 210**

- The (2) two leaf contacts are held together by a web. This design offers greater stability.

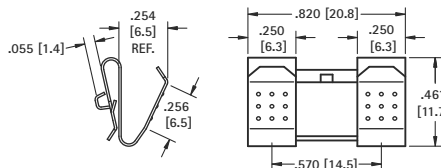

**MATERIAL:** .012 (.30) Spring Steel, Nickel Plate



**CAT. NO. 291** Right

**CAT. NO. 290** Left (shown)

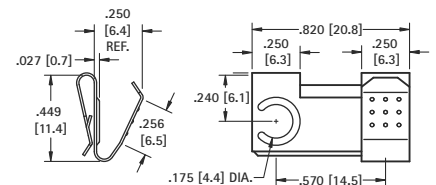

**MATERIAL:** 012 (.30) Spring Steel, Nickel Plate