

DO NOT SCALE DRAWING

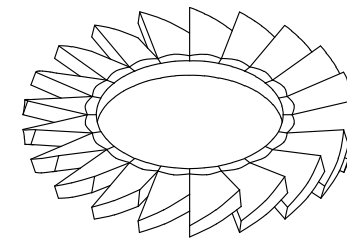
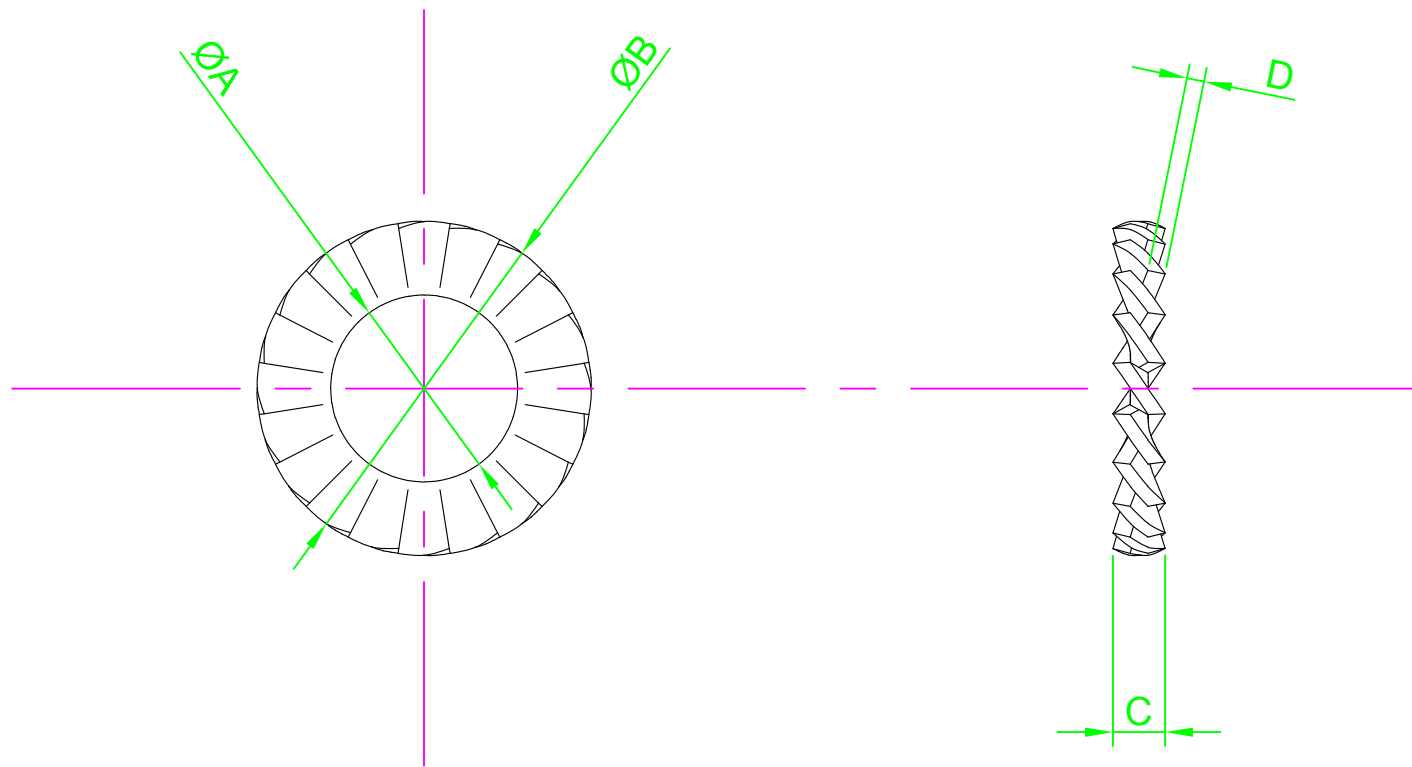

REVISION

A INITIAL DRAWING 17.9.15

Part Number	ØA Nom	ØB Max	C Nom	D Nom	Min No. of Teeth
DM2 - FEST-Z100	2.20	4.5	0.9	0.3	9
DM2.5 - FEST-Z100	2.70	5.5	1.2	0.4	9
DM3 - FEST-Z100	3.20	6.0	1.2	0.4	9
DM3.5 - FEST-Z100	3.70	7.0	1.5	0.5	10
DM4 - FEST-Z100	4.30	8.0	1.5	0.5	11
DM5 - FEST-Z100	5.30	10.0	1.8	0.6	11
DM6 - FEST-Z100	6.40	11.0	2.1	0.7	12

NOTES:



UNLESS OTHERWISE SPECIFIED:
DIMENSIONS ARE IN MM (MILLIMETERS).
SURFACE FINISH:
TOLERANCES: DIN 6798

MATERIAL:
Spring Steel

TITLE:
External Serrated Lock Washer DIN 6798A

	NAME	DATE
DRAWN	Darryl Wilson	17.09.15
CHK'D		
APPVD		

HEAT TREATMENT:

DESIGN RIGHT. TR FASTENINGS LTD, 2003
UNDER NO CIRCUMSTANCES MUST THIS
DRAWING BE COPIED OR DISCLOSED
WITHOUT FIRST OBTAINING WRITTEN
AUTHORITY.

CUSTOMER PART NUMBER:
N/A

FINISH:
TC1D - Commercial ZInc/Clear Trivalent
De-Embrittled

DRAWING NUMBER:
DFEST-Z100

A4

PROJECTION

